

2017

SASH: Student Academic Showcase and Honors 2017

Roger Williams University

Follow this and additional works at: https://docs.rwu.edu/student_academic_showcase



Part of the [Scholarship of Teaching and Learning Commons](#)

Recommended Citation

Roger Williams University, "SASH: Student Academic Showcase and Honors 2017" (2017). *Student Academic Showcase and Honors*. 1.
https://docs.rwu.edu/student_academic_showcase/1

This Document is brought to you for free and open access by the Office of Academic Affairs at DOCS@RWU. It has been accepted for inclusion in Student Academic Showcase and Honors by an authorized administrator of DOCS@RWU. For more information, please contact mwu@rwu.edu.

Roger Williams University

SASH 2017

Student Academic Showcase and Honors

A celebration of scholarship and creative activities for undergraduate and graduate students.

The mission of SASH is to provide an opportunity for undergraduate and graduate students to share their academic and creative activities with the RWU community. SASH represents our collective intellectual accomplishments as a university during the academic year.



Université al Qaraouiyine
The World's Oldest University, Fes, Morocco

Monday, April 17- Friday April 21 — SAAHP Showcase
Showcase of Continuous Exhibits and Displays (SAAHP)

Monday, April 17 — Student Multimodal Display

- 8:00am — 10:00 am “REVEALED” (Mary Tefft White)
- 10:15am — 12:15pm “Project Intersectionality: Social Conflict as Functional in A Quest for Equality,” Justice, Equality, Critical Thinking & Praxis (Mary Tefft White)
- 12:30pm — 2:30pm “Specter Detectors: Vulnerability Risk Assessment in the Era of Homeland Security,” Justice, Equality, Critical Thinking & Praxis” (Mary Tefft White)

Tuesday, April 18 — Student Research Spotlight — Posters

- 10:00am — 12:00pm — Poster Session (Mary Tefft White)
- 12:30pm — 2:30pm — Poster Session (Mary Tefft White)

Tuesday April 18 — Keynote Address — 3:30pm — 5:00pm — GHH Atrium

The Syrian Civil War and Refugee Crisis: From Bad to Worse

Ora Szekely, Assistant Professor of Political Science, Clark University

Professor Szekely is an Assistant Professor at Clark University in Worcester, Massachusetts. She has a B.A., from Cornell University, an M.A. from the University of Chicago, and a Ph.D. from McGill University. She is the author of several articles and her book, *The Politics of Militant Group Survival in the Middle East: Resources, Relationships, and Resistance*, was published by Springer this year. The book examines the foreign and domestic policies of militant organizations in the Middle East, especially Hamas, Hizballah, Amal, and the PLO. She teaches courses on comparative politics, ethnic politics, and a capstone seminar on civil war.



Wednesday April 19 — Student Research Spotlight — Posters

- 8:00am — 10:00 am — Poster Session (Mary Tefft White)
- 10:15am — 12:15pm — Poster Session (Mary Tefft White)
- 12:30pm — 2:30pm — Poster Session (Mary Tefft White)

Wednesday April 19 — Honors Academic Showcase

2:30pm — 6:30pm — Honors Concurrent Sessions (CAS)

Wednesday, April 19 — Music Showcase

4:00pm — 5:00pm — Music Showcase (CAS 152)

The Fifth Annual SASH is sponsored by the University Honors Program, Faculty Senate, and the Provost's Office (www.rwu.edu/go/sash)

SASH 2017 — Student Academic Showcase and Honors

Monday April 17 — Multimodal Presentation — 10:15am - 12:15pm — Mary Tefft White

“Project Intersectionality: Social Conflict as Functional in A Quest for Equality”

Justice, Equality, Critical Thinking & Praxis

Students:

Rebecca Anderson
Bernadette Benman
Gina DiCiancia
Maura Dickson
Elizabeth Furtado

Kaitlin Massey
Laura Merolla
Joshua Morrell
Katherine Vaugh
Katherine Vicente

Faculty Sponsor: Yolanda M. Leott, School of Justice Studies

Monday April 17 — Multimodal Presentation — 12:30pm — 2:30pm — Mary Tefft White

“Specter Detectors: Vulnerability Risk Assessment in the Era of Homeland Security”

Justice, Equality, Critical Thinking & Praxis

Students:

Nicholas Amodio
Holly Barden
Michael Barry
Gregory Battison
Brian Callaghan
Adam Chin
John Clary
Nicholas Dillon
Nicholas Edwards
Amie Evans
Charles Flannagan

Hadassah Gomez
Brandon Kemmy
Chad Ketch
Victoria Kosowski
Brett Libby
Alec Meigs-Rives
Mariela O’Neill
Meaghan O’Rourke
Nicholas Souza
Shannon Wilcox

Faculty Sponsor: Yolanda M. Leott, School of Justice Studies

SASH 2017 — Student Academic Showcase and Honors

Tuesday April 18 — Student Research Spotlight — Posters — 10:00am - 12:00pm		
Student(s)	Title	Faculty Sponsor
Olivia Fritz 1 Student	Advocacy PEN Project	Braver
Nicole Angeley Christina Cascione Erika Daley Elise Frank Courtney Kaufman	Preservice Teacher Rounds: Learning Collaboratively from Compelling Problems of Practice	Donnell
Madison Guitard	An Interdisciplinary Approach to Computational Neurostimulation	Dougherty
Elizabeth Anthes Kyle Peahl	Status of Green Building Incentives and Mandates in Countries Around the World	Ghanem/Celik
Richard Sleight Jonathan Henze	Examining Common Issues Encountered During Management of Construction Projects	Ghanem/Celik
Wesley Caruso Kristi Perreault Meghan Hatzipetro Alex Vorfeld Tyler Perron Andrew Holt	Intelligent Ground Vehicle	McPheron
Joseph Albina Elliott Allen Nicholas Burkle Anthony D'Amico Jake Deslandes Gregory Logue Briana Tremblay Wyatt Trottier Andrew Wasik	The Companion Cycle: An Electric Power-Assisted Tricycle for Two	Palm
Alexandra Townsend 4 Students	Fed Challenge	Panday/Kula
Dillon Costa Brady Schoner Jeb Stewart Alexandra Threadgill	High Throughput Adhesives Test Platform	Potter
Steve Enos Joe MacLellan Ian Mitchell Max Plasker Jonathan Pope Sara Vose Tana Wu	IEEE Solar Splash Collegiate Competition	Potter
Rachel Kampersal	Bruins Nation: A Study of Fandom and Identity	Ram

SASH 2017 — Student Academic Showcase and Honors

Rachel Maloney	The Changing American Family: Viewer Experience and Engagement with Parenthood	Ram
Margaret Pegno	Killing Ourselves for the Love of the Sport: Eating Disorders and Athletes	Ram

Tuesday April 18 — Student Research Spotlight — Posters — 12:30pm - 2:30pm

Student(s)	Title	Faculty Sponsor
Timothy Lopes Anthony J. Core	Public Private Partnership: Lessons Learned	Ghanem/Celik
Nicole Capistran Ryan Mellen Joseph Sojka Taylor Winnick	Creating a Concrete Canoe	Martino
Lindsey Lopez	Marketing to Women of Color: The Impact of Eurocentric Beauty Standards	Matos
Erica Misilo	Integrating Deaf & Hard of Hearing Into Workplace Culture	Shelton
Jessica Blute	Hilary Clinton's Last Six Months 2016	Shelton
Alissa McGheehan	Wells Fargo	Shelton
Chandler Capozzi	Tire Safety Campaign	Shelton
Jacqui Garofalo	Political News in Campaign Cycle: A Content Analysis	Shelton
Sydney Clapp	Political News in Campaign Cycle: A content Analysis	Shelton
Alex Morel	PR Case Study	Shelton
Sharilynn Brown	Self-Image and Social Media	Shelton
Hien Ngo	Numerical Solutions of the Radiosity Equation(Brightness) via the Galerkin Method: Mars Project	Warnapala
Qiuyang Deng	Numerical Solutions of the Radiosity Equation by the Galerkin Method for the Spherical Pyramid (Mars Project)	Warnapala
Kellie Dean Ellen Cook Lauren Fletcher	Minimizing Waste in Upper Commons	Warnapala
Qiuyang Deng Kangii Chen Lance Dengelegi	The Cost of Tuition at RWU	Warnapala
Hien Ngo Mary Stone-Murphy Andrew DelSanto	Domino's Pizza Deliveries to RWU	Warnapala
Luke Nigro Paige Dutko Jakub Lis	Maximizing Bond Profits	Warnapala
Juliette Caffrey Eleanor Phetteplace Olivia Ryan	The Changing Relationship between Ozone Hole Size and Number of Diagnosed Melanoma Cases	Warnapala

SASH 2017 — Student Academic Showcase and Honors

Deborah Kleinclaus Trung Nguyen Hiba Wakidi	A Mathematical Approach: Dye-Sensitized Solar Cells	Warnapala
Ashley Crane Matthew D'Amico Jackie Lyons	Animal Growth Model for the Weight of African Lions	Warnapala
Shivang Patel Austin Clough Skyler Roberts	Lapillus Otolith in Laval Rachycentron canadum in the Presence of Increasing Anthropogenic Carbon Dioxide Release	Warnapala
Wednesday April 19 — Student Research Spotlight — Posters — 10:15am - 12:15pm		
Student(s)	Title	Faculty Sponsor
Kerlie Merizier and Jillian Lynch	Forming Impressions: Effects of Facial Expression and Race	Brooks
George Constantinides Matthew Erbacher Alejandro Miguel Matthew Zoccali	Pearson Pile Analysis: Senior Engineering Design	Brunnhoeffer
Alexandra Halligan Amanda Becotte Ashley Crane	A Mathematical Model for the Effects of Fertilization on Nitrogen Concentrations in Unsaturated Soil on Blueberry Farms	Dougherty
Charles Ahl Nicole Capistran Brian Hann Madison Newton	Chrysosphaerella Bloom Dynamics in the Wachusett Reservoir	Jeznach
Alexia Byusa McKenna Everding Jacob LePrevost Joseph Sojka Will Dittman	The Structural Analysis and Redesign of the East Wall of Fort Adams	Martino McKenzie
Kiserian Jackson	Hemocytic Neoplasia in Hard Clams (<i>Mercenaria mercenaria</i>): Assessment of Neoplasia through Flow Cytometry	Smolowitz
M. Tori Agnew	Development of a qPCR Assay to Detect <i>Proctoeces maculatus</i> in the Water Column	Smolowitz
Katie Heisler	Hemocytic Neoplasia in Hard Clams, <i>Mercenaria mercenaria</i>	Smolowitz
Students in POLSC 307: Gender and Politics	Rhode Island Government Appointments Project	Speakman
6 Students	Engineering	Thomas
Dylan Booth Carly Egan Isaac Martin	“REVEALED”	McClure

SASH 2017 — Student Academic Showcase and Honors

Wednesday April 19 — Student Research Spotlight — Posters — 12:30pm - 2:30pm		
Student(s)	Title	Faculty Sponsor
Dan Barron Adel Alanzi	Visible Analyst	Cates
Madison McCormack Makayla D'Urso	Data Analytics to Determine Mix in a Pharmacy Chain	Farhadi
Mikayla Petrucci Brittany Watson	Long Term Budgeting Strategies to Combat Global Diabetes	Farhadi
Lauren Fletcher Sydney Cherella	Residue Calculus	Jacobson
Ashley Crane Calum Tattersfield	Hyperbolic Geometry	Jacobson
Amanda Becotte Alexandra Halligan	Exploring Möbius Transformations with Spherical Photos	Jacobson
Isabella Grafstein Hien Ngo Jess Messina	Morera's Theorem	Jacobson
Emily Goyette Karissa Chandler	Stereographic Projection	Jacobson McKenzie
Sarah Caron	Enterprise Presentation for Chocolate Charms	Nicholas
Erik Karam Justin Elias Adam Heroian	Pop-Up Learning Gamification	Ruoco
Eissa Al-Uqaili Kevin Faria Benjamin Fisk Edward Flynn Abdulwahab Halawani Harrison Quinn Matthew Simonelli	Detecting 21 cm HI-line using Small-scale Radio Astronomy Setup	Thangaraj

SASH 2017 — Student Academic Showcase and Honors

Wednesday, April 19 – Honors Concurrent Sessions

Room CAS 223

Room CAS 227

2:15pm – 2:55pm

“Honors Senior Capstone Presentations” **Group 1**
 2:15pm – **Kate Digan**: “New Chromophoric Compounds for Implementation in Dye-Sensitized Solar Cells”
 2:30pm – **Daniel Barron**: “Pop-Up Game: Adopting a Development Project”

“Honors Senior Capstone Presentations” **Group 2**
 2:15pm – **Emily Wall**: “Vukuzenzele: A Citizen Scholar’s Understanding of Making it as “The Last Priority”
 2:30pm – **Tori Bodozian**: “Jane Austen the Quiet Revolutionary: Social Critique in *Persuasion*”

3:00pm – 3:55pm

“Honors Senior Capstone Presentations” **Group 3**
 3:00pm – **Aletha Spang**: “Feeding Currents in Copepods”
 3:15pm – **Nicole Capistran**: “Wachusett Reservoir Operations and its Effect on Water Quality”
 3:30pm – **Ellen Cook**: “Health Economics: A Study of the Impact of Planned Parenthood Closures on Adolescent Health Outcomes”

“Honors Senior Capstone Presentations” **Group 4**
 3:00pm – **Kellie Dean**: “When the Commonwealth Doesn’t Provide: Examining the Impact of the RI Conservation Districts’ Slashed Budgets”
 3:15 pm - **Megan Dulong**: “The Impact of Teaching American Sign Language to Hearing Students.”

4:00pm – 4:55pm

“Honors Senior Capstone Presentations” **Group 5**
 4:00pm – **Allie Townsend**: “Vita Gioiosa”
 4:15pm – **Paige Dutko**: “Economic Policy in Modern Society”
 4:30pm – **Christopher Hanson**: “Advertising and its Positive Relationship with the Community”

“Honors Senior Capstone Presentations” **Group 6**
 4:00pm – **Myles Hoponick**: “Preventing PTSD in Soldiers During Combat Deployments”
 4:15pm – **Sarah Quinn**: “BuzzFeed Quizzes as a Tool for Self”
 4:30pm – **Sarah Lynch**: “The Rhode Island Consent Decree No. CA14-175: Analyzing Immediate and Future Impacts for a Diverse Audience.”

5:00pm – 5:55pm

“Honors Senior Capstone Presentations” **Group 7**
 5:00pm – **Sadie Peden**: “Education Research into Practice”
 5:15pm – **Alexander Miller**: “Associations among Locus of Control, Perceptions of Stress and Performance in College”
 5:30pm – **Anastasia O’Neill**: “St. Mary’s Episcopal Church: Architectural History and Preservation Possibilities”

“Honors Senior Capstone Presentations” **Group 8**
 5:00pm – **Rebecca Metivier**: “Exploring Methods for Detecting Thiocyanate Ion Excreted by Fish Exposed to Cyanide”
 5:15pm – **Brittany Pereira**: “Romantic Relationships in the Social Media Era”
 5:30pm – **Kristi Perreault**: “Intelligent Ground Vehicle Algorithm Design”

SASH 2017 — Student Academic Showcase and Honors

6:00pm – 6:55pm

“Honors Senior Capstone Presentations” **Group 9**

6:00pm – **Carla Puchini**: “Behavioral Finance in the scope of female investing”

6:15pm – **Cayley Dorr**: “Nasty: Choreographing Identity”

6:30pm – **Meaghan Ryan**: “Women in Policing: An Investigation of Workplace Culture Within Police Departments”

“Honors Senior Capstone Presentations” **Group 10**

6:00pm – **Tess Berkowitz**: “The Changing Meaning of Family in The United States as Reflected Through Homosexual Marriage and Child Custody Rights in the Courtroom”

6:15pm – **Laura Anderson**: “Optimizing egg production and evaluating hobbyist perception of the bluestreak cleaner wrasse *Labroides dimidiatus*”

6:30pm – **Nicholas Burkle**: “Companion Cycle”

SASH 2017 — Student Academic Showcase and Honors

April 17-21 SAAHP STUDENT EXHIBITS—Architecture Building

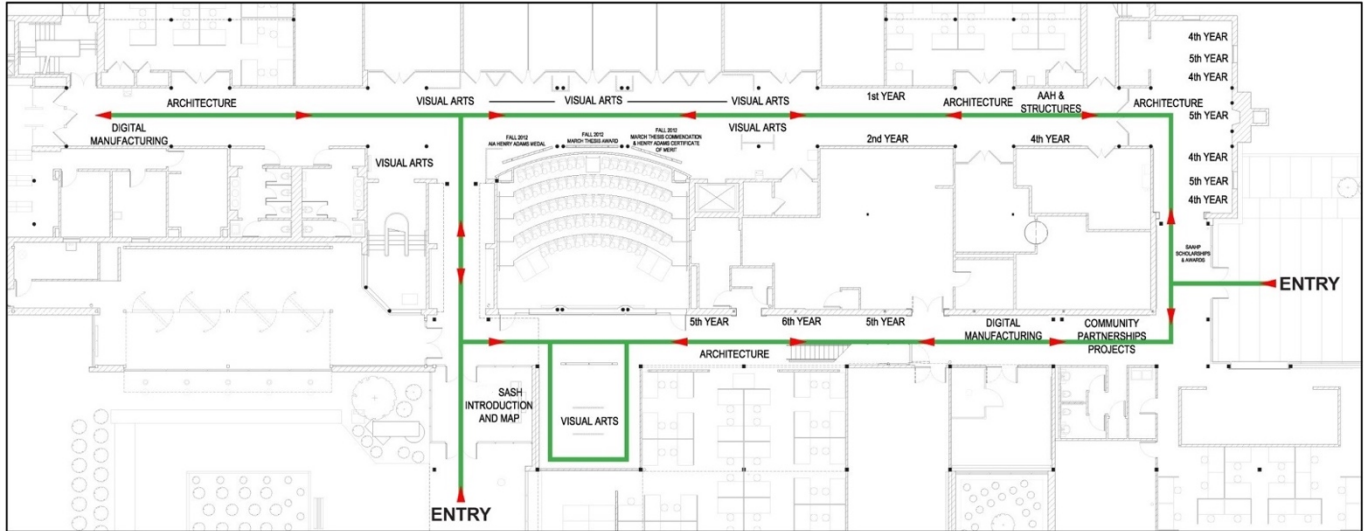

STUDENT ACADEMIC SHOWCASE AND HONORS (SASH) EXHIBITION MAP

School of Architecture, Art and Historic Preservation | SAAHP Atrium Gallery

— SAAHP EXHIBITION LINE

Other Related Events during SASH Week

Wednesday, April 19, 11:00am — 2:00pm, Earth Fest in celebration of Earth Day, D'Angelo Common, in front of the Library.

SASH 2017 Planning Committee

Joseph W. Roberts, Chair of SASH 2017 Planning Committee and Chair, University Life Committee of the Faculty Senate
 Robert Cole, Associate Provost and Interim Dean, College of Arts and Sciences
 Becky Spritz, Director Honors Program

Bonita Cade
 Elizabeth Duffy
 Christine S. Fagan
 Farbod Farhadi
 Amiee Shelton
 Roxanne Smolowitz
 Jenny K. Tsankova

Thank You to the following for their assistance with SASH 2017

Anne Marie-Cerda
 Jim Lemire
 Joi Lewis

Office of the President
 University Life Committee of the Faculty Senate
 Participating Academic Programs
 Conferences

The Student Academic Showcase and Honors program is organized by the University Life Committee of the Faculty Senate and the 2017 SASH Committee. It is sponsored by the Office of the Provost for Academic Affairs and the University Honors Program. All events are free and open to the public.